

**LEGEND:**

PROPOSED FOUL WATER.....	
PROPOSED SURFACE WATER.....	
PROPOSED BIORETENTION / RAINGARDEN.....	
PROPOSED INFILTRATION BASIN.....	
PROPOSED PERMEABLE PAVING.....	
PROPOSED FILTER DRAIN.....	
PROPOSED GRASSED SWALE.....	
PROPOSED CATCHMENT PIT.....	
PROPOSED LANDSCAPED FOOTPATH.....	
EXISTING DITCH.....	
PROPOSED INTERMITTING KERB.....	
PROPOSED HEADWALL.....	
EXISTING FOUL WATER.....	
EXISTING SURFACE WATER.....	
EXISTING 3m FOUL WATER WAYLEAVE (BOTH SIDES).....	
EXISTING 3m SURFACE WATER WAYLEAVE AND INFILTRATION BASIN AREA (BOTH SIDES).....	
EXISTING 5m SURFACE WATER WAYLEAVE (BOTH SIDES).....	
EXISTING INFILTRATION BASIN.....	
PROPOSED RED LINE BOUNDARY.....	
EXISTING RISING MAIN.....	
EXISTING CLASS 1 BYPASS INTERCEPTOR.....	

**KEY**

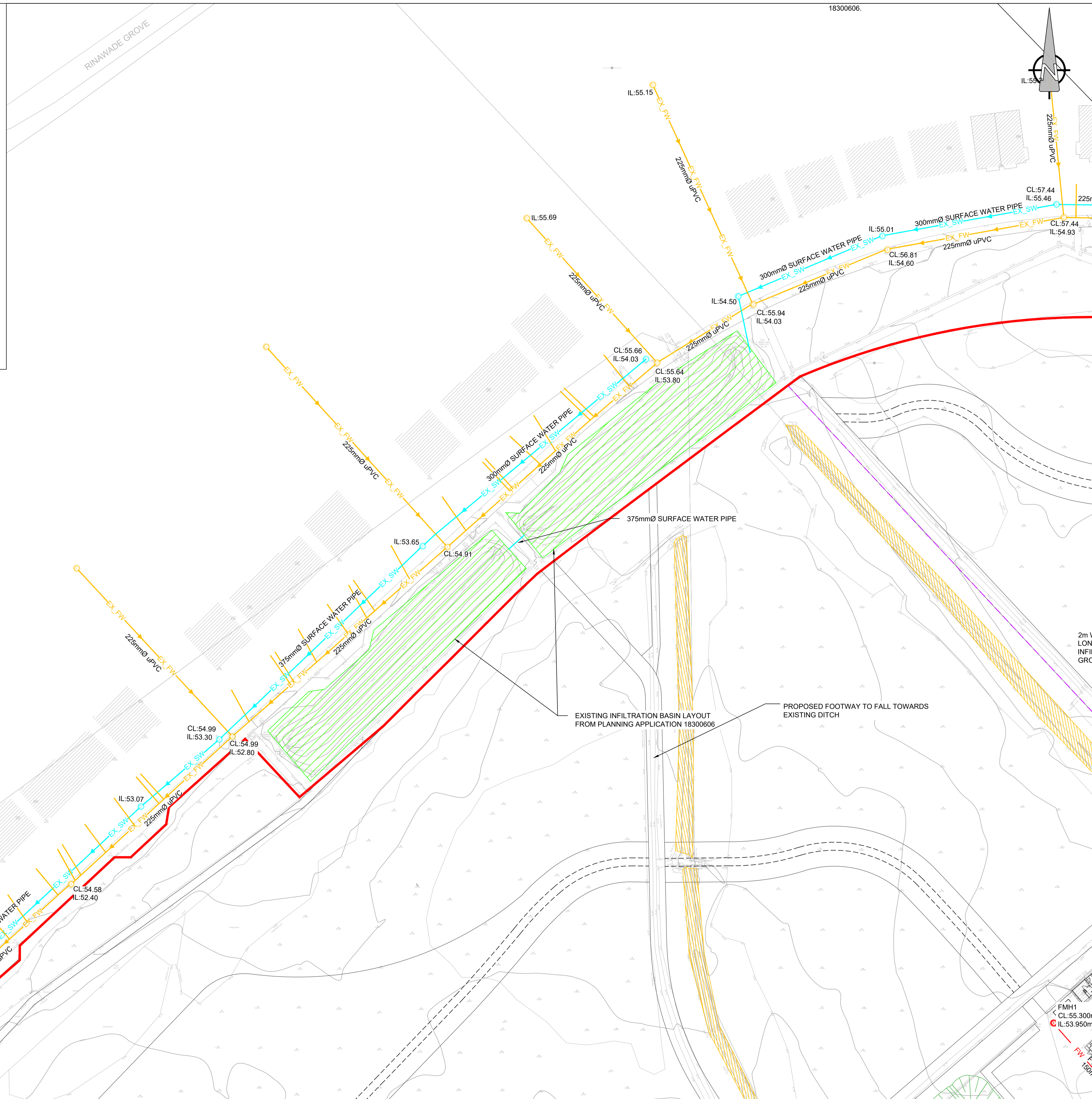
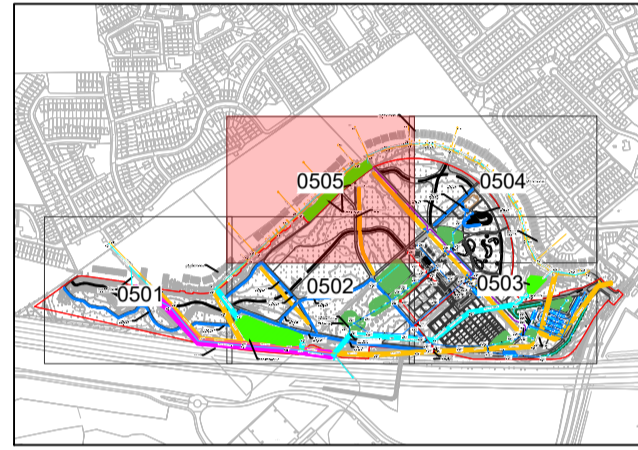

This drawing has been prepared for the use of AECOM's client. It may not be used, modified, reproduced or relied upon by third parties, except as required by law. AECOM accepts no responsibility, and denies any liability, whatsoever, to any party that uses or relies on this drawing without AECOM's express written consent. All measurements must be obtained from the stated dimensions.

**AECOM**

**PROJECT**  
 PART 8 PROPOSED REDEVELOPMENT OF THE WONDERFUL BARN P82024.10  
 CELBRIDGE RD, BARNHALL, LEIXLIP, CO. KILDARE  
 CLIENT  
 KILDARE COUNTY COUNCIL  
 CONSULTANT  
 AECOM  
 Adelphi Plaza  
 George's Street Upper  
 Dun Laoghaire Co. Dublin  
 +353 (0) 1 696 6200 tel  
 www.aecom.com

- NOTES**
- THIS DRAWING IS TO BE READ IN CONJUNCTION WITH ALL OTHER RELEVANT ARCHITECTURAL AND ENGINEERING DRAWINGS. ANY DISCREPANCIES, ERRORS OR OMISSIONS TO BE BROUGHT TO THE ATTENTION OF THE DESIGNER.
  - DRAWINGS TO BE READ IN CONJUNCTION WITH LANDSCAPE'S ARCHITECT DRAWINGS.
  - ALL DIMENSIONS TO BE CHECKED BY THE CONTRACTOR ON SITE PRIOR TO COMMENCEMENT OF WORKS.
  - AECOM LIMITED TO BE INFORMED BY THE CONTRACTOR OF ANY DISCREPANCIES PRIOR TO THE COMMENCEMENT OF WORKS ON SITE.
  - DIMENSIONS OF ALL BOUNDARIES AND ADJOINING ROADS TO BE CHECKED ON SITE PRIOR TO COMMENCEMENT OF WORKS.
  - DO NOT SCALE. ALL MEASUREMENTS AND COORDINATES TO BE CHECKED ON SITE.
  - EXISTING SERVICES SHOWN ON DRAWINGS ARE BASED ON PUBLIC RECORDS AVAILABLE AT THE DATE OF THIS PLANNING APPLICATION. RECORDS COULD BE INACCURATE, THEREFORE SHOULD BE VERIFIED VIA GPR AND MANHOLE SURVEY.
  - THE FOLLOWING TOPOGRAPHIC SURVEY HAVE BEEN USED TO DEVELOP THE DESIGN: MGS57199\_T\_2d
  - THE LOCATION & DEPTH OF SERVICES TO BE CHECKED ON SITE PRIOR TO COMMENCING ANY WORKS.
  - MANHOLE COVERS AND FRAMES IN PUBLICLY ACCESSIBLE AREAS SHALL BE HEAVY DUTY CAST IRON, CLASS D400, DOUBLE SEALED AND LOCKABLE TYPE COMPLYING WITH BS EN 124-2:2015.
  - GULLY GRATINGS & FRAMES SHALL COMPLY WITH BS EN 124-2:2015.
  - EXISTING INVERT LEVELS TO BE VERIFIED ON SITE BEFORE COMMENCING CONSTRUCTION.
  - SURFACE WATER & FOUL SEWER PIPES LESS THAN 1.2m BELOW THE ROAD SURFACE OR LESS THAN 0.9m IN NON-TRAFFICKED FOOTPATHS AND LANDSCAPE AREAS (WITH AN ABSOLUTE MINIMUM DEPTH OF COVER ABOVE THE EXTERNAL CROWN OF THE PIPE Ø750mm) SHALL BE PROTECTED FROM DAMAGE BY PROVIDING MINIMUM 150mm THICK CONCRETE C16/20 HAUNCH IN ACCORDANCE WITH IS EN 12620.
  - ATTENUATION PROPOSALS SHALL BE IN ACCORDANCE WITH THE REQUIREMENTS OF THE LOCAL AUTHORITY.
  - RAINWATER BUTTS TO BE INSTALLED AT THE BACK OF EACH PROPOSED DWELLING.
  - CCTV SURVEY TO BE CONDUCTED PRIOR TO COMMENCEMENT OF ANY WORKS TO DETERMINE THE CONDITION AND VERIFY LEVELS OF THE EXISTING FOUL AND SURFACE WATER PIPES/ MANHOLES. ANY SUB-STANDARD OR DEFECTIVE ELEMENTS OF THE EXISTING PIPES/MANHOLES TO BE REPORTED AND CORRECTED.
  - ALL SURFACE WATER DRAINAGE DETAILS TO BE IN ACCORDANCE WITH THE GREATER DUBLIN STRATEGIC DRAINAGE STUDY AND THE GREATER DUBLIN REGIONAL CODE OF PRACTICE FOR DRAINAGE WORKS.
  - ALL FOUL WATER DETAILS TO BE IN ACCORDANCE WITH THE IRISH WATER INFRASTRUCTURE STANDARD DETAILS AND CODE OF PRACTICE FOR WASTEWATER INFRASTRUCTURE.
  - LOCATION OF INFILTRATION TESTS BASED ON THE IGSL SITE INSPECTIONS (REPORT No. 25030).
  - PROPOSED MANHOLES WITH COVER TO GROUND BETWEEN 750mm AND 1.2m TO BE CONCRETE SURROUNDED.
  - FOR DRAINAGE NETWORK TABLES REFER TO DRAWING 60689541-ACM-XX-00-DR-CE-10-0506.
  - FOR PROPOSED SUDS SYSTEMS LAYOUT PLEASE REFER TO DRAWING 60689541-ACM-XX-00-DR-CE-10-0520.

**ISSUE/REVISION**

I/R	DATE	DESCRIPTION
0	05.06.2024	ISSUED FOR PART 8

**PROJECT NUMBER**  
60689541

**SHEET TITLE**  
PROPOSED DRAINAGE LAYOUT  
SHEET 5 OF 5

**SHEET NUMBER**  
60689541-ACM-XX-00-DR-CE-10-0505